

309CAM40/22

APPLICATION

Automatic high pressure groups coupled with self priming jet pumps. They are very silent and reliable and particularly suitable to increase pressure from a water system, to supply water from wells and in domestic high pressure groups.



OPERATING CONDITIONS

- Liquid temperature up to 35°C
- Ambient temperature up to 40°C
- Total suction lift up to 8 m
- Continuous duty

MOTOR

- Two-Pole induction motor (n = 2850 min-1)
- Insulation Class F
- Protection IP 44

MATERIALS

- Butyl membrane tank
- Flexible hose with connection
- Adjusted switch on/off pressure 1,4- 2,8 bar with cable
- Pressure gauge
- Brass connection

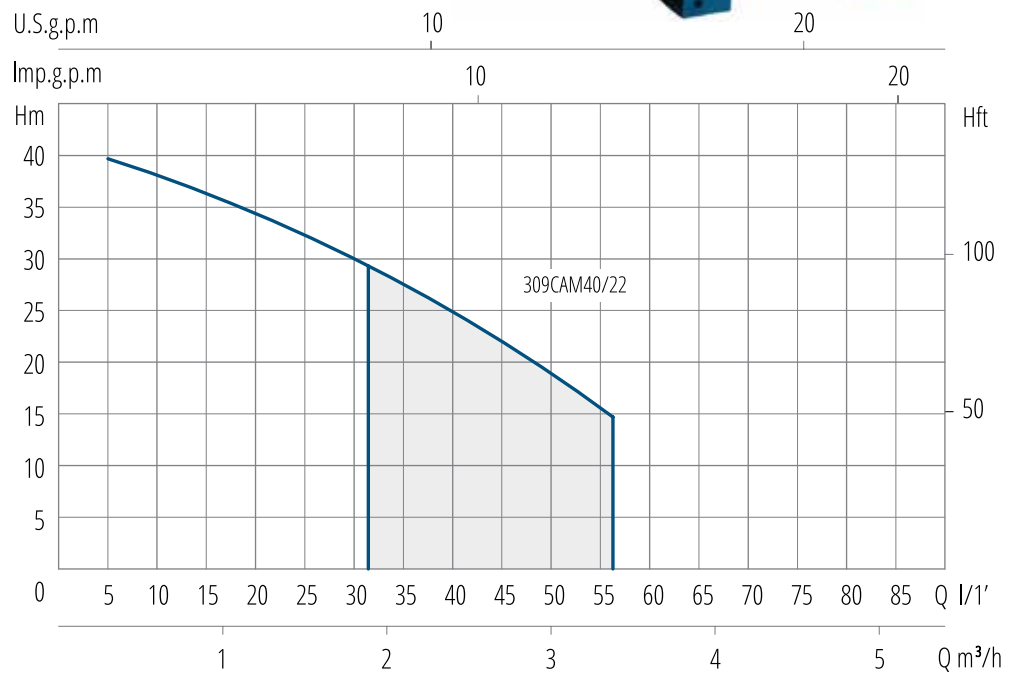

TYPE	NOMINAL POWER		INPUT POWER	AMPERE	Adjusted switch on/off pressure	Q = CAPACITY									
	P2	P1				Single-phase		Total head in meters w.c.							
230V-50Hz	HP	KW	KW	1 x 230V	Bar	m ³ /h	0,6	0,9	1,2	1,5	1,8	2,1	2,4	2,7	3
309CAM40/22	0,8	0,6	0,8	3,8	1,4-2,8	H(m)	38	36	34	32	29	27	25	22	19

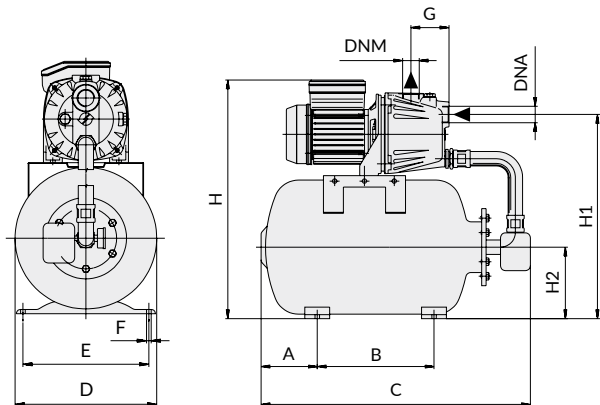

TYPE	DIMENSIONS mm												WEIGHT Kg
	A	B	C	D	E	F	G	H	H1	H2	DNA	DNM	
309CAM40/22	113	235	542	270	240	9	76	480	411	144	1"	1"	14