

# SUBMERSIBLE CUTTING PUMPS



309CUTTY250T

## APPLICATION

The Cutty series comprehend electric pump with plunged impeller, this impeller is multi-pipe, open, with a cutting system in the suction. It is particularly suitable in presence of long, filamentous or fibrous fibres, of destroyable solids also of big dimensions and in biologic liquids or in civil waters.



## OPERATING CONDITIONS

- Liquid temperature 0 - 35°C (according to EN 60335-2-41) up to 50°C (for other uses)
- Maximum immersion depth 20 m (with a cable of the appropriate length)
- Min. suction level 80 mm
- Continuous duty

## MOTOR

- Insulation Class F
- Protection IP68
- Thermic protection (only single-phase)

## MATERIALS

- Motor body - Cast Iron
- Pump body - Cast Iron
- Impeller - Cast Iron
- Shaft with rotor - Stainless Steel AISI 304
- Cutting - Stainless Steel AISI 304
- Double mechanical seal in oil chamber - Ceramic/Graphite/NBR
- Silicon/Silicon/NBR

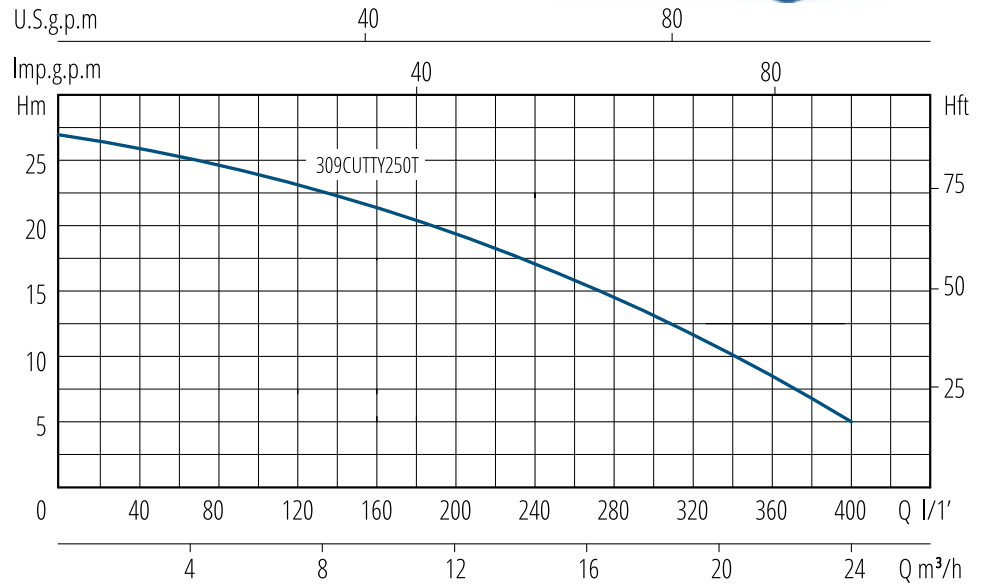

TYPE	NOMINAL POWER		INPUT POWER	AMPERE	Q = CAPACITY									
	P2				P1	Three-phase								
Three-phase	HP	kW	kW	Three-phase	m³/h	0	3	6	9	12	15	18	21	24
230/400V-50Hz				3 x 400V	lt/1'	0	50	100	150	200	250	300	350	400
309CUTTY250T	2,5	1,85	2,7	4,8	Total head in meters w.c.									
					H (m)	27	26	25	22	19	16	10	9	5

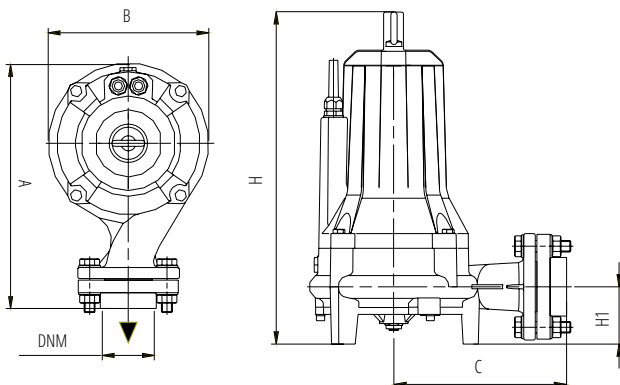

TYPE	DIMENSIONS mm							WEIGHT
Three-phase	A	B	C	H	H1	DNM	CABLE	kg
309CUTTY250T	305	206	200	468	72	1"2	10 mt H07RN8-F	45